

Installation and Operational Guide

This instruction manual serves as a guide for the Apollo F-6™.

Mounting Instructions:

See illustration for mounting information

- 1.) Place the unit with flange against the selected mounting surface.
- 2.) Mark the areas where the mounting holes will be drilled. If mounting surface is part of the vehicle, make sure no vital components could be damaged by the drilling process.
- 3.) Drill two mounting holes in the marked surface, as well as a 0.5" diameter hole for wire passage (if mounting on a vehicle). Make sure to de-burr holes thoroughly.
- 4.) Pass the wires through the 0.5" diameter hole, and secure the lighthouse to the mounting surface with the provided hardware.

SCREW

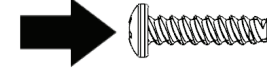

HOUSING

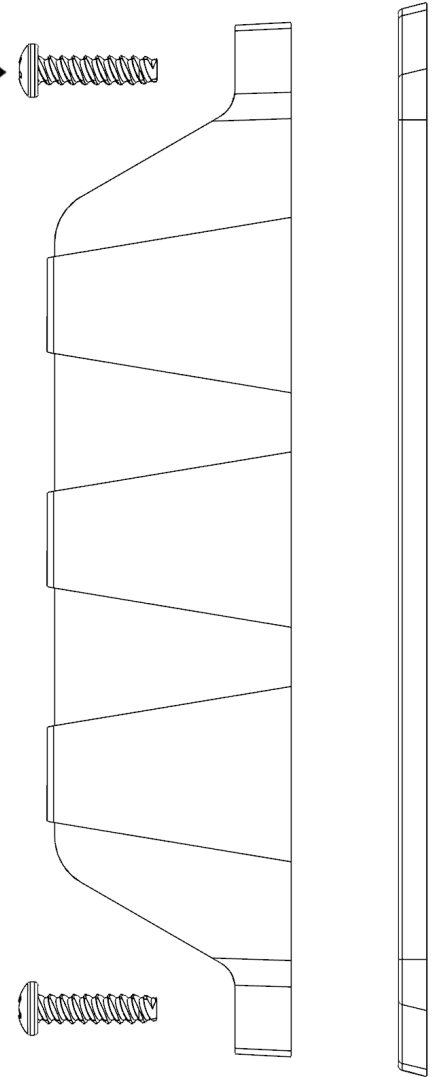

GROMMETT

WIRING DIAGRAM

Wiring Instructions:

- 1.) To activate the unit, extend the red (+) or yellow (+) wire to a 12V post. Extend the black (-) wire to the ground post of the vehicle's battery. Please note that mode 2 over rides mode 1.
- 2.) Momentarily connect the blue wire to the Ground (12V-) to cycle through the flash patterns.
- 3.) Synchronization: To Sync two or more light heads together:
 - A.) Apply 12V+ power to the the red (+) or yellow (+) wire and apply 12V- to the black wire to power the unit on.
 - B.) Cycle through all patterns by tapping the blue (flash pattern changer) wire to the activated black, ground wire until the steady burn pattern is selected.
 - C.) Connect one of the same colored mode wires (red or yellow) of the two lighthouse together; connect the black wires of the light heads together and then connect the blue wires of the light heads together.

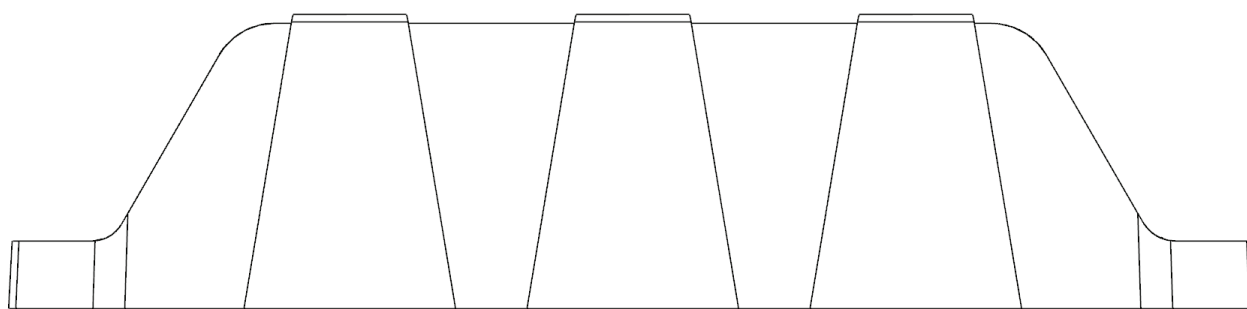

Alternate Light Heads:

D.) Follow Steps A-B

E.) For the light heads to alternate, one lighthouse must be set as master and the other as slave. To do so, hold the blue (flash pattern changer) wire to ground for 3 seconds. If all LEDs turn on this indicated master mode. If half the LEDs activate this indicates slave mode.

F.) Follow Step C. Change patterns by tapping the blue wire to the activated black, ground wire.

- Red wire = Positive, Mode 1
- Yellow wire = Positive, Mode 2
- Blue wire = Flash pattern Changer/Sync
- Black wire = Negative, Ground

Color: Red Blue Amber White Green

SINGLE COLOR FLASH PATTERN LIST

The flash patterns are listed in consecutive order of appearance. To select a certain flash pattern, start with a recognizable pattern and use the blue wire to cycle through patterns.

Single Color Models: Patterns:

1) Brake Mode
2) Steady On
3) Single Slow
4) Single Fast
5) Single Combo
6) Double Slow
7) Double Fast
8) Double Combo
9) Quad Slow
10) Quad Fast
11) Quad Combo

DUAL COLOR FLASH PATTERN LIST

The flash patterns are listed in consecutive order of appearance. To select a certain flash pattern, start with a recognizable pattern and use the blue wire to cycle through patterns.

Function Patterns:

1) Brake Mode Color 1
2) Brake Mode Color 2
3) Steady On Color 1
4) Steady On Color 2

Color 1 Patterns:

5) Single Slow Color 1
6) Single Fast Color 1
7) Single Combo Color 1
8) Double Slow Color 1
9) Double Fast Color 1
10) Double Combo Color 1
11) Quad Slow Color 1
12) Quad Fast Color 1
13) Quad Combo Color 1

Color 2 Patterns:

14) Single Slow Color 2
15) Single Fast Color 2
16) Single Combo Color 2
17) Double Slow Color 2
18) Double Fast Color 2
19) Double Combo Color 2
20) Quad Slow Color 2
21) Quad Fast Color 2
22) Quad Combo Color 2

Dual Color Patterns: No Off Time:

23) Single Slow
24) Single Fast
25) Single Combo
26) Double Slow
27) Double Fast
28) Double Combo
29) Quad Slow
30) Quad Fast
31) Quad Combo

With Off Time:

32) Single Slow
33) Single Fast
34) Single Combo
35) Double Slow
36) Double Fast
37) Double Combo
38) Quad Slow
39) Quad Fast
40) Quad Combo